



granvia

Serrano



new PLAN  
developments







## About the Developer

New Plan Developments is a shareholding company that has five outstanding projects in the New Administrative Capital which are Serrano, Eleven, Atika, Tonino Lamborghini, Granvia, in addition to one of our luxurious projects in Port Said City Éclat.

All with a modern, unique perspective towards a soul-enriching lifestyle, New Plan Developments takes pride in its success through a proven track record of inspirationally dynamic communities. In order to satisfy all the needs of our families, youth & businessmen.

# Introduction

The first mall on the commercial city walk .

Contemporary, sleek, and luxurious, Granvia defines the lifestyle mall in our age with outstanding facilities and amenities.



## Prime Location

Flawless in every aspect, Granvia's location has been masterfully selected in the New Capital's R7 district. Granvia is the first mall on the commercial city walk, and is accessible by two main roads just to add to your convenience. Granvia is situated right outside of Serrano residence, 80m from the main road, in proximity to the Medical center, physiotherapy center, mosque, 2 social clubs, and a gas station.



## Facilities

Granvia is built on 7000 square meters of space and consists of 3 floors that fulfill different purposes.

- Ground Floor: Cafes and Retailers
- First Floor: Shops and the hypermarket
- Second Floor: Medical Units (sold out)





**Cafés**



**Shops**



**Hypermarket**



**Medical Units**

# Exterior

The Ultra-modern dynamic design of Granvia emphasizes the phrase "simplicity is best", the sleek design is inviting and gives an awe factor to all visitors and passers-by in addition to the landscape complementing the exterior of the building.





# Interior

Elegantly decorated interior corridors with a sense of uniformity in the elevators, escalators, and stylish doors. The breathtaking skylight pertains to the love of biophilic design, incorporating natural sunlight lightens the mood giving Granvia a unique vibe that will leave a lasting impression on the visitor's mind.



# Granvia Mall

- No. of Floors: Ground Floor + First Floor + Second Floor
- Ground Floor shops areas: Starting from 33 m<sup>2</sup> to 116 m<sup>2</sup>
- First Floor shops areas: Starting from 21 m<sup>2</sup> to 125 m<sup>2</sup>
- Second Floor (Clinics): Starting From 53 m<sup>2</sup> to 198 m<sup>2</sup>
- Out door areas: Starting from 30 m<sup>2</sup> to 151 m<sup>2</sup>
- Hyper market area: 1095 m<sup>2</sup>
- Total no. of shops: 33 shops ( 20 Ground Floor + 13 First Floor)
- Total no. of Clinics: 22 Clinics



Ground Floor Plan

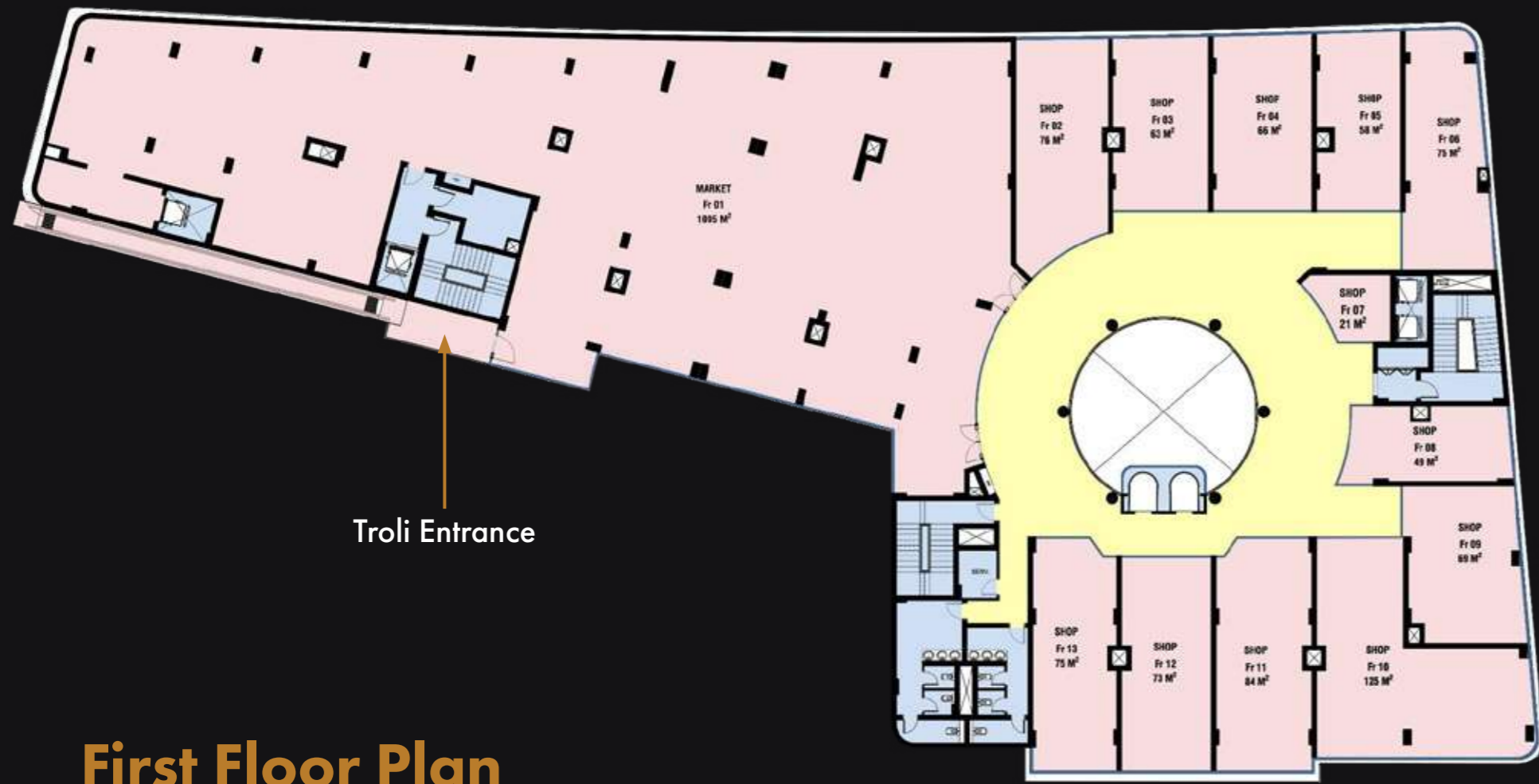

**First Floor Plan**



**Second Floor Plan**

## Contacts

16534

[www.newplandevlopments.com](http://www.newplandevlopments.com)

Raya Building, Land Number 5 ,133th  
Settlement, New Cairo, Egypt.